

NOTE:  
THIS DRAWING HAS BEEN REDUCED TO FIT ON AN  
8 1/2"x11" SHEET OF PAPER. DO NOT SCALE.

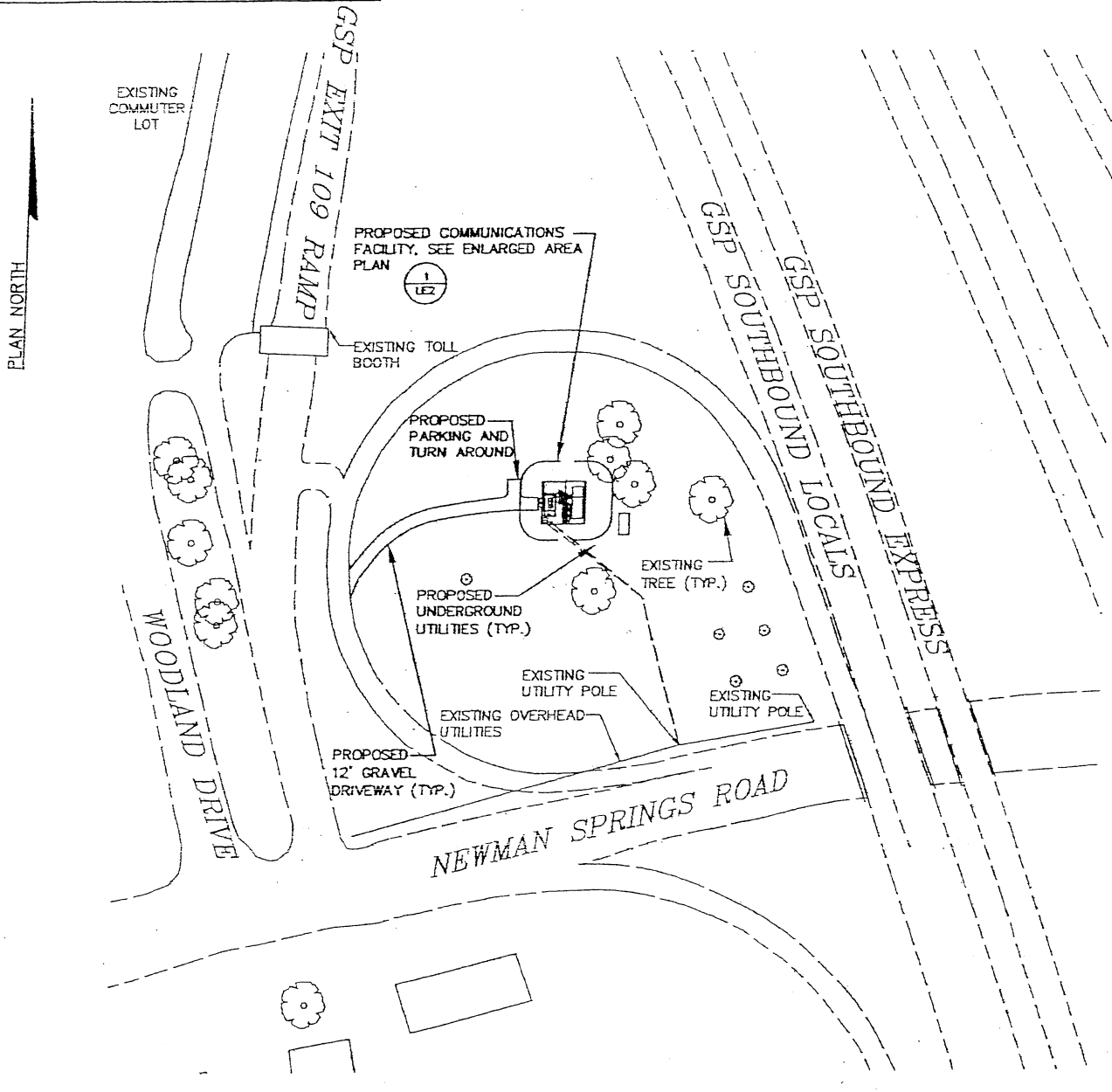

PLAN NORTH

PROPOSED COMMUNICATIONS FACILITY, SEE ENLARGED AREA PLAN

EXISTING TOLL BOOTH

PROPOSED PARKING AND TURN AROUND

PROPOSED UNDERGROUND UTILITIES (TYP.)

EXISTING UTILITY POLE

EXISTING OVERHEAD UTILITIES

PROPOSED 12' GRAVEL DRIVEWAY (TYP.)

EXISTING TREE (TYP.)

EXISTING UTILITY POLE

NEWMAN SPRINGS ROAD

GSP SOUTHBOUND LOCALS

GSP SOUTHBOUND EXPRESS

WOODLAND DRIVE

GSP EXT 109 RAMP

EXISTING COMMUTER LOT

NOTES:

1. THIS DRAWING IS BASED ON DISCUSSIONS WHICH TOOK PLACE IN THE FIELD AND ON LIMITED FIELD MEASUREMENTS. THIS PLAN DOES NOT REPRESENT AN ACTUAL FIELD SURVEY.
2. THIS DRAWING IS CONCEPTUAL AND HAS BEEN PREPARED ONLY TO PROMOTE DISCUSSIONS BETWEEN THE LESSOR AND THE LESSEE.

1  
LE-1 ENLARGED AREA PLAN  
SCALE: N.T.S.

<p>670 NORTH BEERS STREET BUILDING 3 HOLMDEL, NEW JERSEY 07733 732.986.7700</p> <p>254-B MOUNTAIN AVENUE, SUITE 301 HACKETTSTOWN, NEW JERSEY 07840 908.850.0877</p>	<p>PROJECTING: 06N044A</p>	<p><b>Omnipoint</b> COMMUNICATIONS, INC. 4 SYLVAN WAY PARSIPPANY, NJ 07054</p>	<p>DRAWING TITLE LEASE EXHIBIT</p>			
	<p>DRAWN BY K.T.P.</p>		<p>APPROVED/CHECKED BY S.P.K.</p>	<p>PROJECT: NJ-08-393A</p> <p>ADDRESS: GSP EXIT RAMP 109 SB MIDDLETOWN, NJ 07738</p>	<p>REVISION#</p>	<p>DATE#</p>
	<p>SIGNATURE</p>	<p><small>THIS DOCUMENT IS THE PROPERTY AND COPYRIGHTED WORK OF OMNIPPOINT FACILITIES NETWORK, LLC. ANY DUPLICATION OR USE WITHOUT EXPRESS WRITTEN CONSENT IS STRICTLY PROHIBITED.</small></p>			<p>0</p>	<p>2/15/06</p>
					<p>NJ-08-393A</p>	
					<p>LE-1</p>	<p>0</p>